

THE SITE PLAN

Windsor Apartments at Prince of Wales Drive

The layout and design of the development incorporates light and inviting communal open spaces including a piazza, café and ornamental pond. These 2.5 acres of landscaped gardens are set against a modern, well-appointed architectural backdrop to striking effect.

As part of a mixed-tenure development Windsor Apartments homes are available for sale through the Shared Ownership scheme with Clarion Housing and is part of a car-free development with excellent public transport links and easy access to cycle routes.

Residents will have the advantage of a free 12-month membership of the local Car Club - please speak to your sales agent for further information.

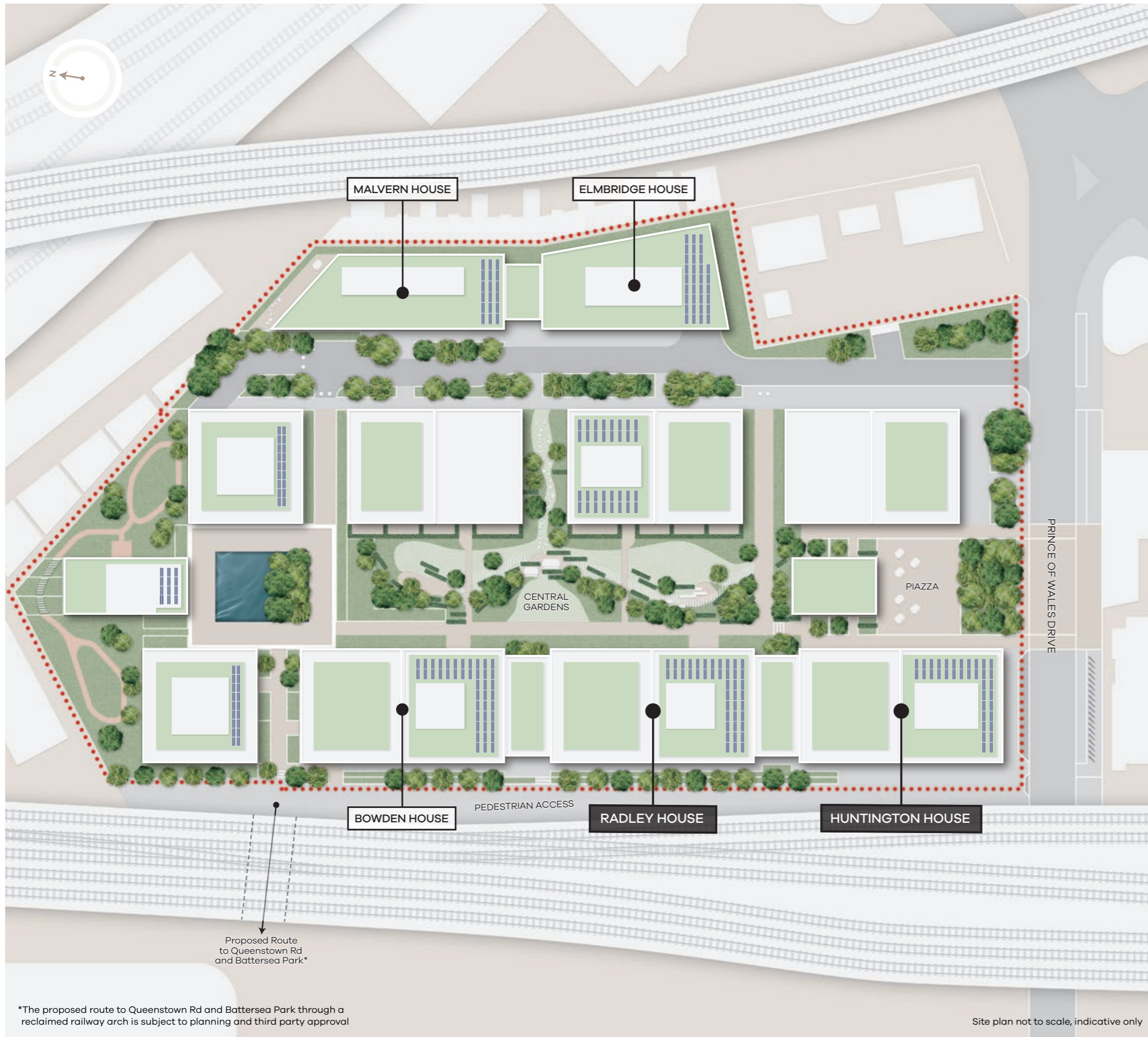

*The proposed route to Queenstown Rd and Battersea Park through a reclaimed railway arch is subject to planning and third party approval

Site plan not to scale, indicative only



This View
Looking south west across the pond to Bowden House (foreground) and Radley House.